

THIS DOCUMENT AND ATTACHMENT(S) ARE AVAILABLE FOR DOWNLOAD AT
<https://mrscrosters.bonfirehub.com/opportunities/218093>
AN EMAIL NOTIFICATION WAS SENT TO REGISTERED DOCUMENT TAKERS. FAILURE TO
ACKNOWLEDGE RECEIPT ON THE BID FORM DOES NOT AFFECT THE BIDDER'S
OBLIGATION FOR COMPLIANCE.



ADDENDUM NO. 1

WASHINGTON STATE PARKS AND RECREATION COMMISSION
OCEAN CITY STATE PARK
FISH BARRIER REMOVAL INTERIOR CULVERTS
SW-C1359

DATE: February 13, 2026

ATTENTION TO PLANHOLDERS OF RECORD. The following revisions are hereby made a part of the Contract Documents. Please be sure to acknowledge all Addenda on the Bid Form.

PROJECT MANUAL

I. CHANGES TO SPECIFICATIONS

Replace: Page 33 of DIVISION 6, WSDOT SPECIAL PROVISIONS (Changes the quantity of HIGH VISIBILITY SILT FENCE to 127)

II. CHANGES TO DRAWINGS

Replace: Sheet 16 of 43 (515 ROAD PLAN & PROFILE)

Replace: Sheet 20 of 43 (515 SITE PREP & TESC PLAN)

Replace: Sheet 35 of 43 (515 CULVERT PLAN)

Replace: Sheet 41 of 43 (515 RESTORATION PLAN)

Attachments:

- Page 33 of Division 6, WSDOT Special Provisions (1 page)
- Ocean City FBR Sheets and Views (4 pages)

Jason Bologna

Jason Bologna, Public Works Coordinator
Contracts and Grants Program

02/13/26

Date

END OF ADDENDUM NO. 1

1
2
3
4
5

(*****)

Pipe Culvert 515 Installation contains the following approximate quantities of materials and work:

ITEM	UNIT	TOTAL QUANTITY
MOBILIZATION	L.S.	1
CLEARING AND GRUBBING	L.S.	1
REMOVAL OF STRUCTURES AND OBSTRUCTIONS	L.S.	1
ROADWAY EXCAVATION INCL. HAUL	C.Y.	25
GRAVEL BORROW INCL. HAUL	TON	15
EMBANKMENT COMPACTION	C.Y.	5
CHANNEL EXCAVATION INCL. HAUL	C.Y.	5
STREAMBED SAND	TON	10
CL. V REINF. CONC.CULV. PIPE 36 IN. DIAM.	L.F.	30
TEMPORARY STREAM DIVERSION	L.S.	1
CRUSHED SURFACING BASE COURSE	TON	20
CRUSHED SURFACING TOP COURSE	TON	10
HMA CL. 1/2 IN. PG 58H-22	TON	10
ESC LEAD	DAY	7
MEDIUM COMPOST	S.Y.	35
EROSION CONTROL AND WATER POLLUTION PREVENTION	L.S.	1
SOIL AMENDMENT	S.Y.	45
BARK OR WOOD CHIP MULCH	S.Y.	13
HIGH VISIBILITY SILT FENCE	L.F.	140 127
PLASTIC DRAINAGE MARKING	EACH	2
PERMANENT SIGNING	L.S.	1
CONSTRUCTION SIGNS CLASS A	S.F.	55
STRUCTURE EXCAVATION CLASS B INCL. HAUL	C.Y.	25
GRAVEL BACKFILL FOR PIPE ZONE BEDDING	C.Y.	10
SPCC PLAN	L.S.	1
FIELD OFFICE BUILDING	L.S.	1
UTILITY RELOCATIONS	L.S.	1

6
7
8
9

Pipe Culvert 516 Installation contains the following approximate quantities of materials and work:

ITEM	UNIT	TOTAL QUANTITY
MOBILIZATION	L.S.	1
CLEARING AND GRUBBING	L.S.	1

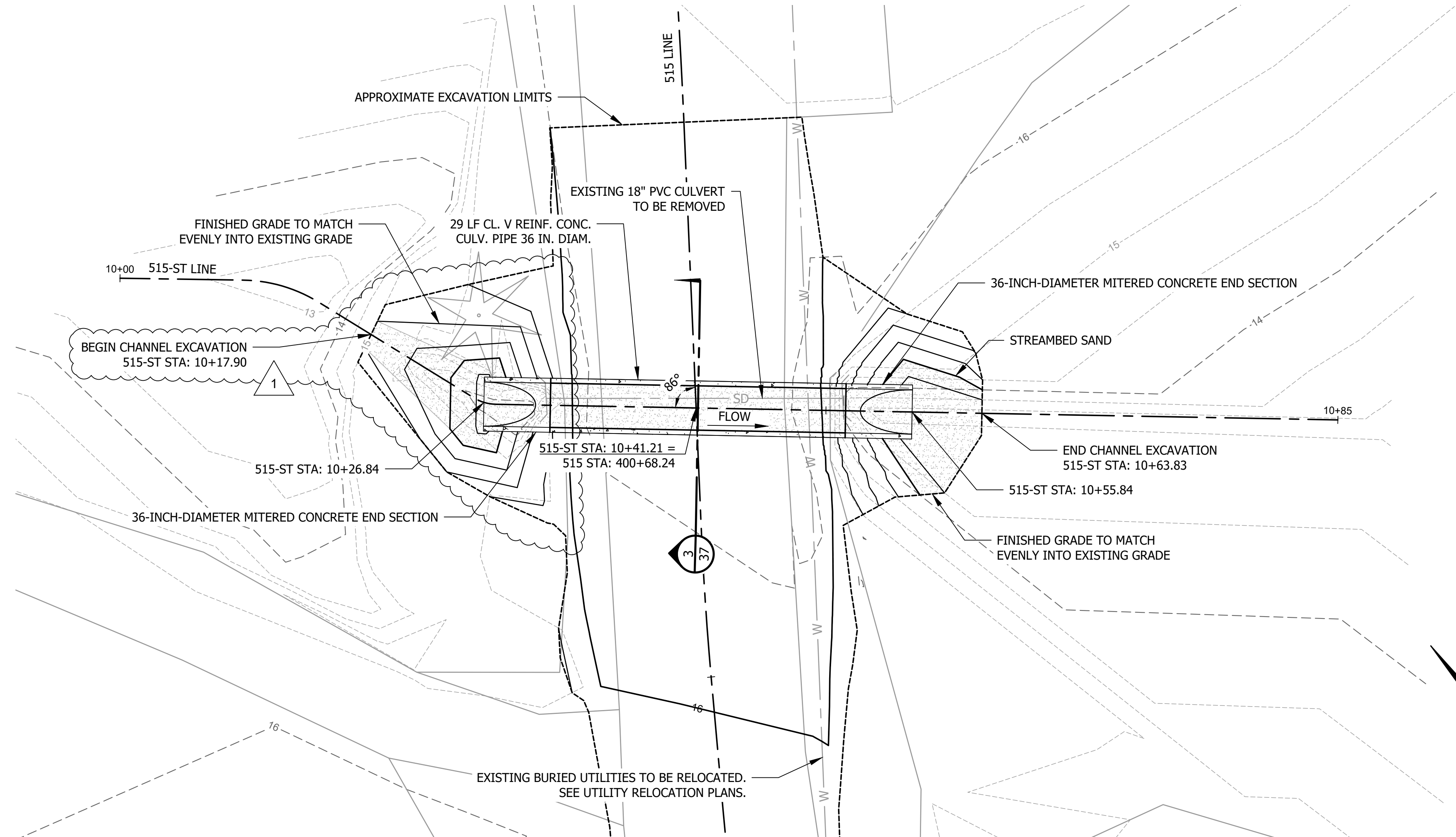

515 CROSSING - STREAM PLAN

GENERAL NOTES:

1. SEE SITE PREP PLANS FOR TESC DETAILS.
2. SEE ROADWAY PLANS FOR ROADWAY DETAILS.
3. SEE RESTORATION PLANS FOR ROADSIDE AND RIPARIAN RESTORATION.
4. CONSTRUCTION AND MATERIAL REQUIREMENTS FOR CULVERT WORK SHALL BE PER WSDOT STANDARD SPECIFICATION 7-02.
5. DEWATERING WILL BE REQUIRED TO ACHIEVE A DRY AND STABLE EXCAVATION. DEWATERING SHALL BE INCIDENTAL TO THIS WORK. TYPICAL GROUNDWATER ELEVATIONS ARE WITHIN THE EXCAVATION, BEDDING, AND BACKFILL OF THE PROPOSED CULVERT. SEE GEOTECHNICAL DATA REPORT IN SPECIFICATIONS FOR GROUNDWATER INVESTIGATIONS.
6. CULVERT ENDS SHALL CONFORM TO WSDOT STANDARD SPECIFICATION 9-05.3(3). ENDS SHALL BE MITERED TO MATCH THE EMBANKMENT SLOPE AND SHALL NOT BE MITERED FLATTER THAN 4H:1V OR STEEPER THAN 2H:1V. WHEN SLOPES ARE SHALLOWER THAN 4H:1V OR STEEPER THAN 2H:1V, SHAPE THE SLOPE IN THE VICINITY OF THE CULVERT END TO ENSURE THAT NO PART OF THE CULVERT PROTRUDES MORE THAN 4 INCHES ABOVE THE FINISH GRADE AND THE MITERED EDGE IS NOT BELOW FINISH GRADE.
7. FIELD CUTTING OF MITERED CONCRETE END SECTIONS IS PERMITTED WHEN APPROVED BY THE ENGINEER.
8. CUT SURFACES OF CONCRETE PIPES AND END SECTIONS SHALL BE RESURFACED WITH MORTAR TYPE 1 FOR CONCRETE SURFACE FINISH IN ACCORDANCE WITH WSDOT STANDARD SPECIFICATION 9-20.4(2).
9. CONSTRUCT A LOW FLOW CHANNEL ALONG THE STREAM ALIGNMENT AS DIRECTED BY THE ENGINEER IN THE FIELD.
10. EXISTING UTILITIES ARE SHOWN IN APPROXIMATE LOCATIONS. SEE UTILITY RELOCATION PLANS FOR MORE INFORMATION.
11. STREAMBED SAND SHALL CONFORM TO WSDOT STANDARD SPECIFICATIONS 8-30 AND 9-03.11(3).

ACTION	BY	DATE	KXTO	CGB	2/11/26
					DATE
DESIGNED	CGB	12/19/25			
DRAWN	KXTO	12/19/25			
CHECKED (FIELD)					
CHECKED (HDQTS.)					

NO.	REVISIONS
1	STREAM GRADING

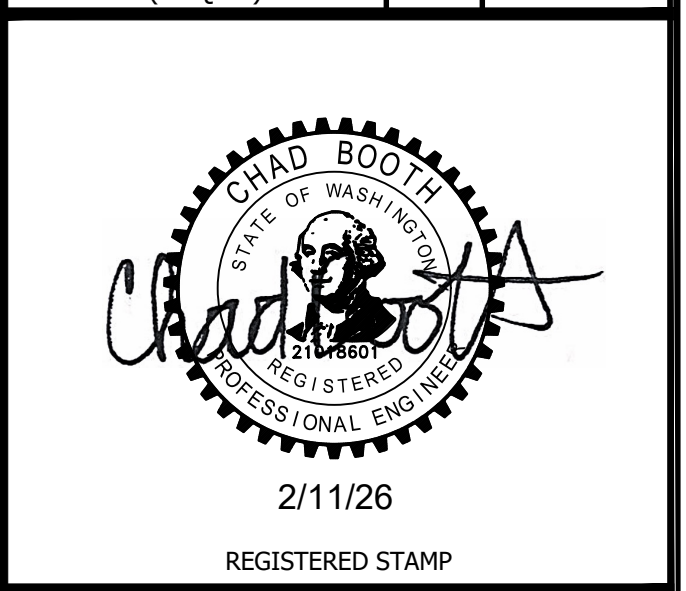

WASHINGTON
STATE
PARKS
AND
RECREATION
COMMISSION

OCEAN CITY
STATE PARK

FISH BARRIER
REMOVAL
INTERIOR
CULVERTS

515 CULVERT PLAN

SCALE VARIES
SEE SHEET

PARKS FILE#

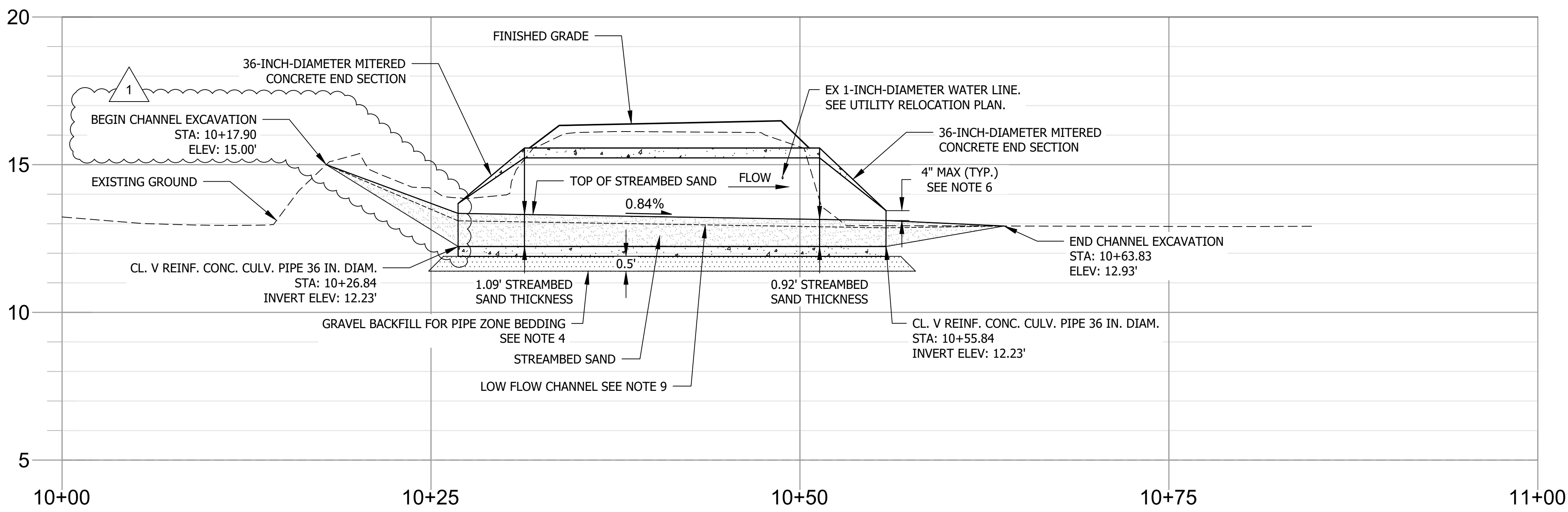

515 CROSSING - STREAM PROFILE
(515-ST LINE)

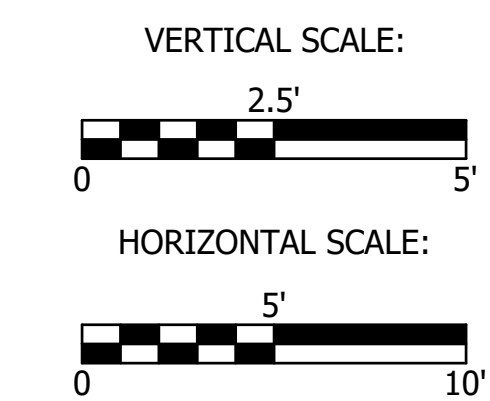

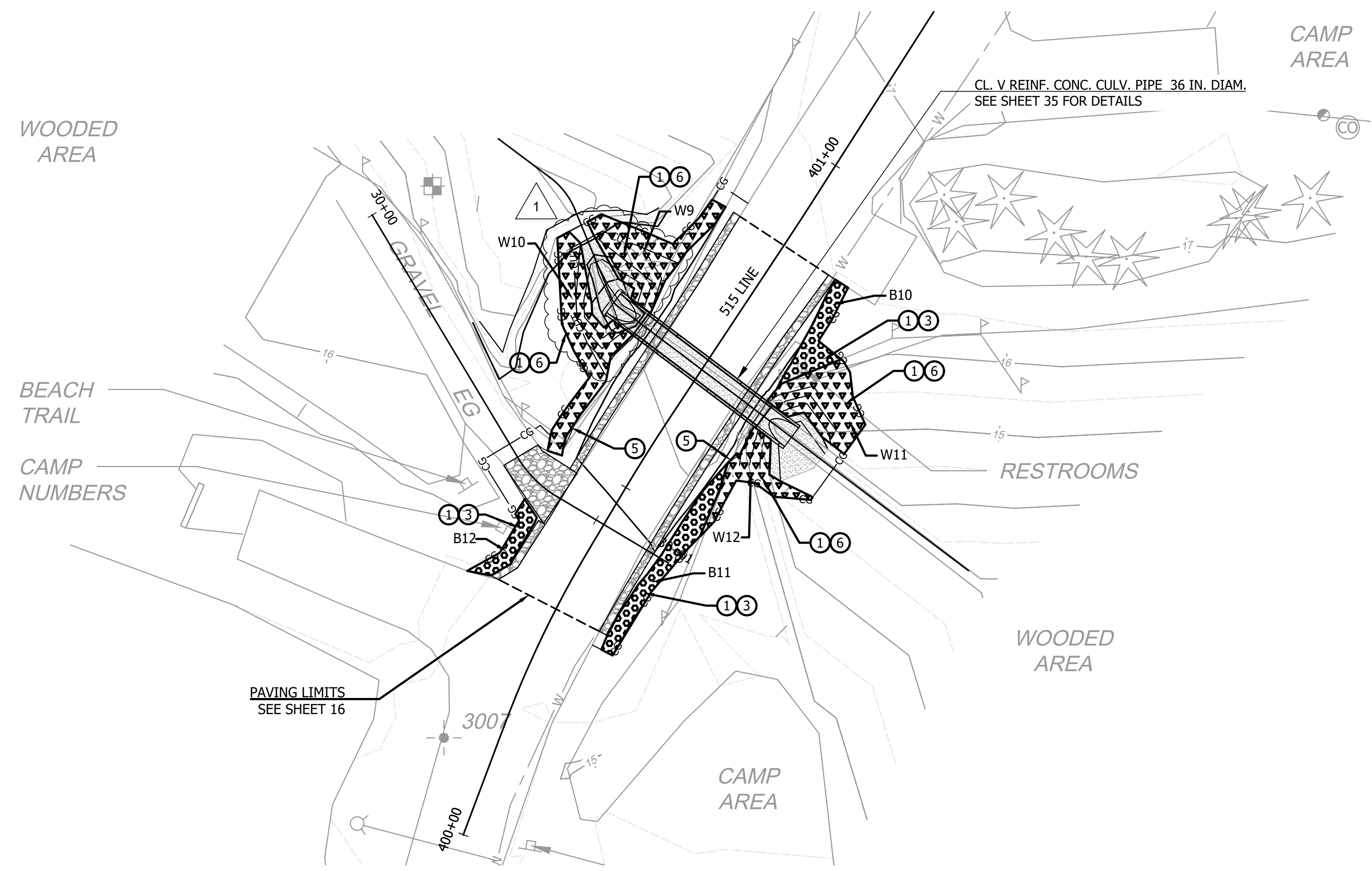

CONSTRUCTION NOTES

- ① AMEND PLANTING AREAS WITH 4" SOIL AMENDMENT INCORPORATED INTO EXISTING SUBGRADE TO A 12" DEPTH PER DETAIL 1, RESTORATION DETAILS SHEET.
- ② DECOMPACT SUBGRADE TO 6" DEPTH AND PLACE 2" FINE COMPOST (WSDOT STANDARD SPECIFICATIONS 9-14.5(8)) PER DETAIL 2, RESTORATION DETAILS SHEET.
- ③ INSTALL 4" DEPTH BARK OR WOOD CHIP MULCH (WSDOT STANDARD SPECIFICATIONS 9-14.5(3)) IN UPLAND AREAS.
- ④ APPLY SEEDING AND MULCHING. SEE SPECIAL PROVISIONS FOR SEED MIX.
- ⑤ NO PLANTING OR SEEDING BEYOND CRUSHED SURFACING BASE COURSE LIMIT (APPROX.)
- ⑥ INSTALL 3" DEPTH MEDIUM COMPOST MULCH (WSDOT STANDARD SPECIFICATIONS 9-14.5(8)) IN WETLAND AREAS.

GENERAL NOTES

- 1. SEE RESTORATION DETAILS SHEET FOR PLANTING DETAILS. SEE SPECIAL PROVISIONS FOR SEED MIX.
- 2. INSTALL SHRUBS IN SINGLE-SPECIES GROUPINGS OF 1-3.
- 3. SEE PLANT SETBACK CHART (RESTORATION DETAILS SHEET) FOR TREE AND SHRUB SETBACKS.
- 4. ENGINEER SHALL APPROVE THE PLANT LAYOUT PRIOR TO INSTALLATION.

	JCGA	2/11/26	DATE
	OXA		APP.
	OXA		INT.
			EXTEND GRADING AND RESTORATION
			REVISIONS
1			NO.

ACTION	BY	DATE
DESIGNED	JCGA	12/19/25
DRAWN	OXA	12/19/25
CHECKED (FIELD)		
CHECKED (HDQTS.)		



WASHINGTON STATE PARKS AND RECREATION COMMISSION

OCEAN CITY STATE PARK

FISH BARRIER REMOVAL INTERIOR CULVERTS

515 RESTORATION PLAN

PLANT SCHEDULE

BOTANICAL NAME	COMMON NAME	CONDITION	W9	W10	W11	W12	B10	B11	B12	SIZE (HT)	SPACING	REMARKS
WETLAND MIX												
SHRUBS												
SALIX SITCHENSIS	SITKA WILLOW	LIVE STAKE	2	2	2	1				36" LENGTH, 3/4" MIN. DIA.	3' O.C.	
SALIX HOOKERIANA	HOOKE'S WILLOW	LIVE STAKE	3	2	1	1					3' O.C.	
SPIRAEA DOUGLASII	DOUGLAS SPIRAEA	NO. 1 CONT.	2	2	2	1				10" MIN. HT.	3' O.C.	WELL BRANCHED
MYRICA GALE	BOG MYRTLE	NO. 1 CONT.	2	2	2	1				10" MIN. HT.	3' O.C.	WELL BRANCHED
HERBACEOUS												
CAREX OBNUPTA	SLOUGH SEDGE	NO. 1 CONT.	2	3	2	1				8" MIN. HT.	3' O.C.	INSTALL NEAR ROAD
LYSICHITON AMERICANUS	SKUNK CABBAGE	NO. 1 CONT.	1	2	1	1				8" MIN. HT.	3' O.C.	
BUFFER MIX												
SHRUBS												
GAULTHERIA SHALLON	SALAL	NO. 1 CONT.					3	4	3	8" MIN. HT.	3' O.C.	INSTALL NEAR ROAD
RUBUS SPECTABILIS	SALMONBERRY	NO. 1 CONT.					1	2		10" MIN. HT.	3' O.C.	WELL BRANCHED
VACCINIUM OVATUM	EVERGREEN HUCKLEBERRY	NO. 1 CONT.					1	1		10" MIN. HT.	3' O.C.	WELL BRANCHED

