

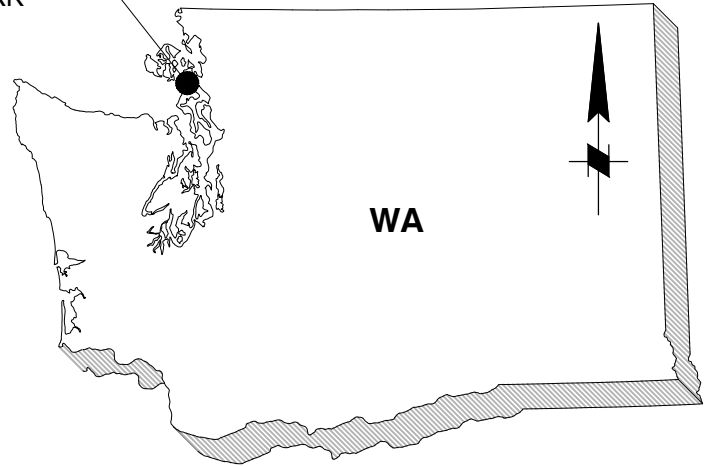

DECEPTION PASS STATE PARK



Area Manager: Jason Armstrong

VICINITY MAP
NOT TO SCALE

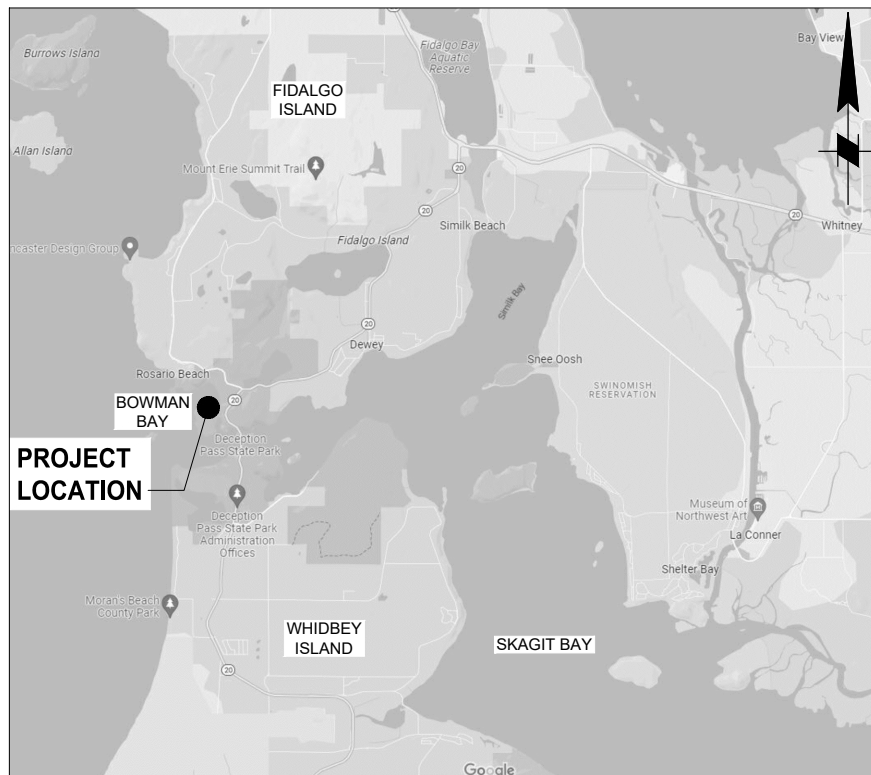

LOCATION MAP
NOT TO SCALE

USACE REFERENCE: TBD

APPLICANT: WASHINGTON STATE PARKS

ADJACENT PROPERTY OWNERS:
1) STATE OF WASHINGTON

LOCATION: BOWMAN BAY
DECEPTION PASS STATE PARK
4399 BOWMAN BAY RD
ANACORTES, WA 98221

LAT/LONG: 48.416573 / -122.651435

SHEET: 1 OF 8 DATE: JUNE 30, 2025

PROPOSED PROJECT: PIER REMOVAL

IN: BOWMAN BAY
NEAR/AT: ANACORTES, WA
COUNTY: SKAGIT STATE: WA
SEC: 23 T: 34 N R: 1 E
DATUM: BOWMAN BAY NAVD88 = 0.0'

DATUMS:
HORIZONTAL DATUM = WASHINGTON STATE PLANE
COORDINATE SYSTEM, NORTH ZONE, NAD83(91), US SURVEY FEET
VERTICAL DATUM = NAVD88, US SURVEY FEET

TIDAL WATER LEVELS (NAVD88):
HIGHEST ASTRONOMICAL TIDE +8.67 FT
ORDINARY HIGH WATER/HIGH TIDE LINE (OHW/HTL) +8.61 FT
MEAN HIGHER-HIGH WATER LEVEL (MHHW) +7.25 FT
MEAN HIGH WATER (MHW) +6.6 FT
MEAN SEA LEVEL (MSL) +4.16 FT
MEAN LOW WATER (MLW) +1.98 FT
MEAN LOWER-LOW WATER (MLLW) -0.47 FT
NAVD88 0 FT
LOWEST ASTRONOMICAL TIDE -4.41 FT

LEGEND:

- OHWM/HTL, 8.61 FT NAVD88
- MHHW, 7.25 FT NAVD88
- MHW, 6.60 FT NAVD88
- TIMBER PILE
- = BATTER PILE
- TURBIDITY CURTAIN
- ⋄ EELGRASS AND
- ⋄ MACROALGAE AREA

**PIER AREA PER
SHORE ZONE AREAS:**

RZ 0 SF
USZ 123 SF
LSZ 4,470 SF
DSZ 1,289 SF

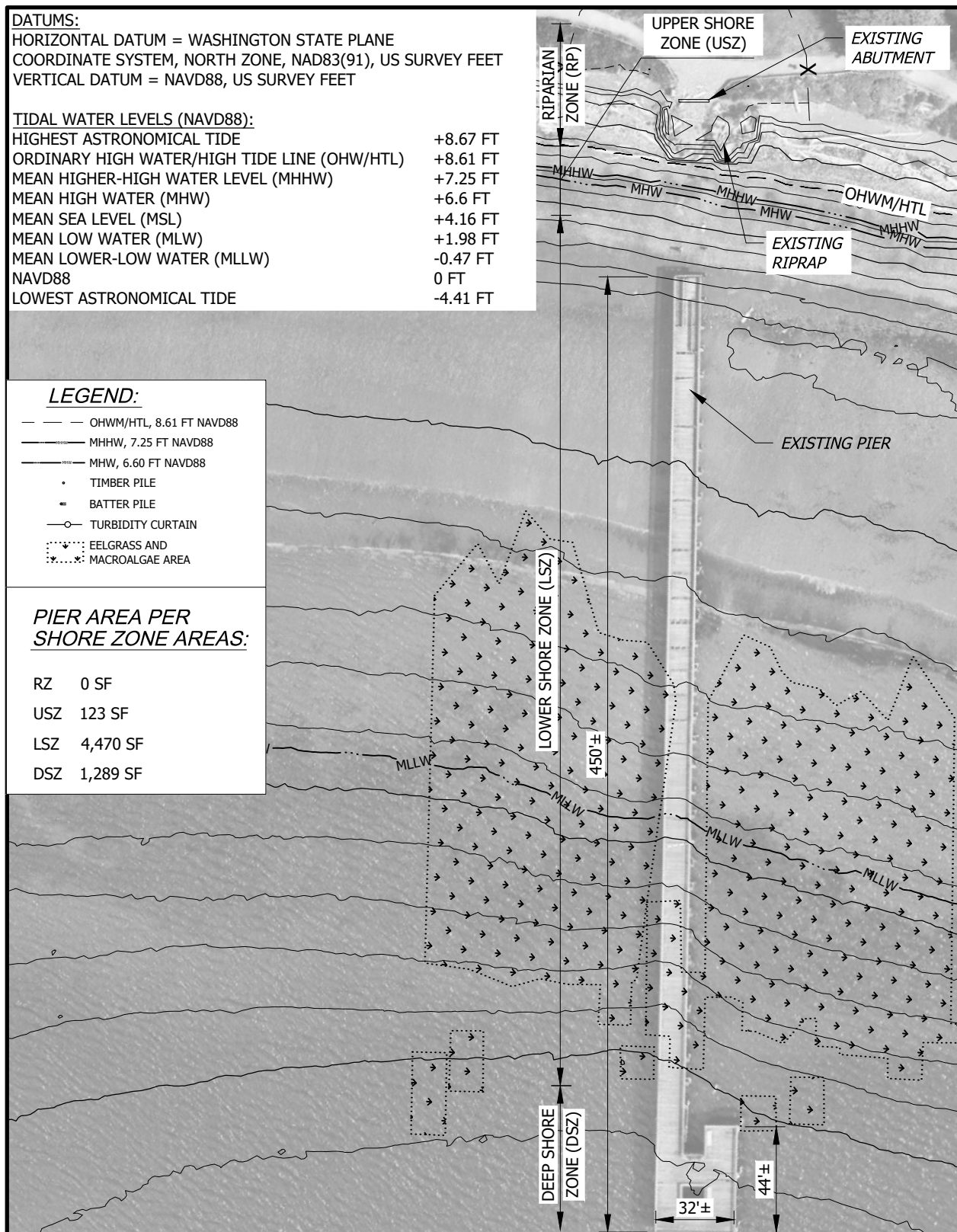

SITE PLAN: EXISTING CONDITIONS

SCALE: 1"=60'



USACE REFERENCE: TBD

APPLICANT: WASHINGTON STATE PARKS

ADJACENT PROPERTY OWNERS:

1) STATE OF WASHINGTON

LOCATION: BOWMAN BAY
DECEPTION PASS STATE PARK
4399 BOWMAN BAY RD
ANACORTES, WA 98221

LAT/LONG: 48.416573 / -122.651435

SHEET: 2 OF 8 **DATE:** JUNE 30, 2025

PROPOSED PROJECT: PIER REMOVAL

IN: BOWMAN BAY
NEAR/AT: ANACORTES, WA
COUNTY: SKAGIT **STATE:** WA
SEC: 23 **T:** 34 N **R:** 1 E
DATUM: BOWMAN BAY NAVD88 = 0.0'



IN: BOWMAN BAY
NEAR/AT: ANACORTES, WA
COUNTY: SKAGIT STATE: WA
SEC: 23 T: 34 N R: 1 E
DATUM: BOWMAN BAY NAVD88 = 0.0'

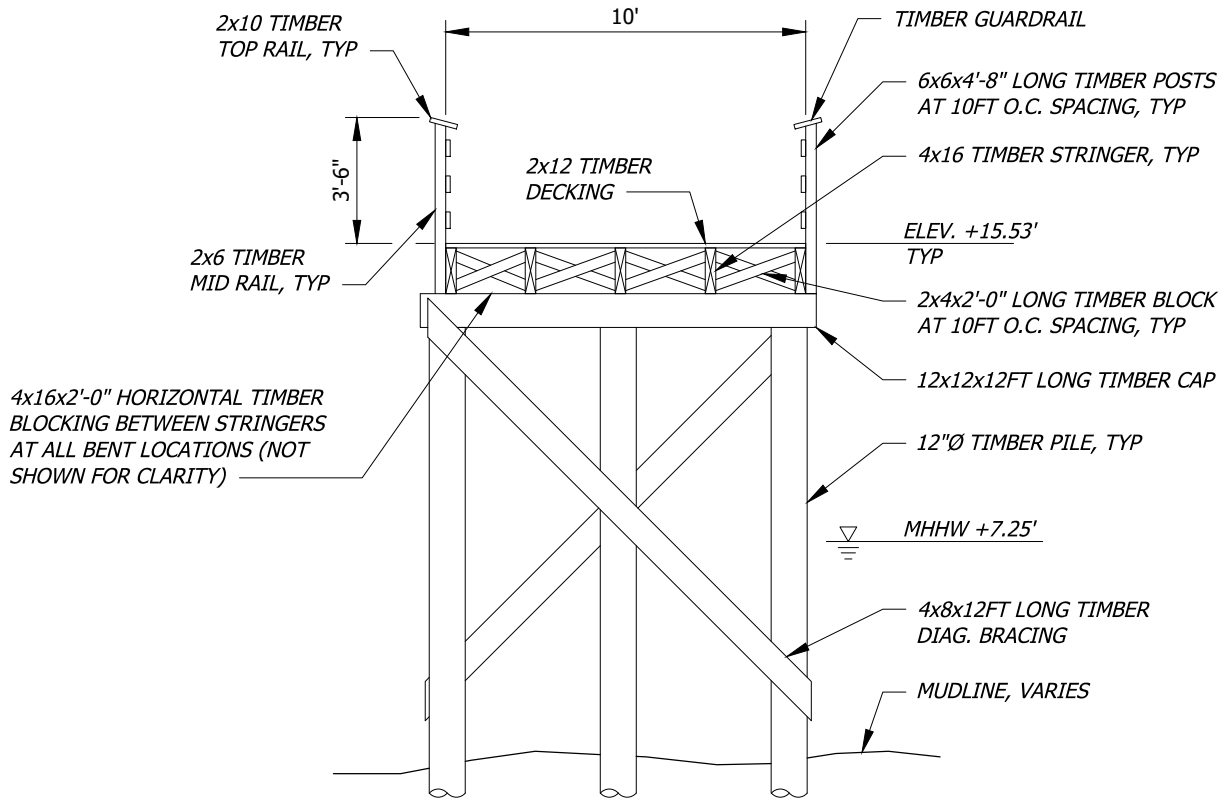

TYPICAL EXISTING PIER SECTION
NOT TO SCALE

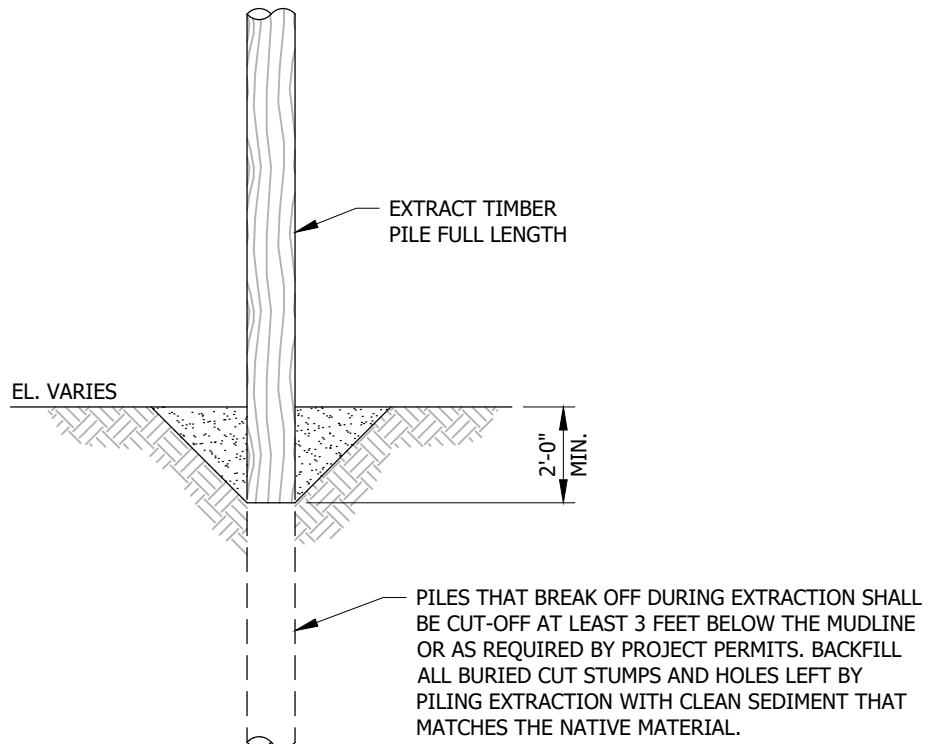

A **PILE CUT-OFF DETAILS**
3, 5 NOT TO SCALE

USACE REFERENCE: TBD

APPLICANT: WASHINGTON STATE PARKS

ADJACENT PROPERTY OWNERS:

1) STATE OF WASHINGTON

LOCATION: BOWMAN BAY
DECEPTION PASS STATE PARK
4399 BOWMAN BAY RD
ANACORTES, WA 98221

LAT/LONG: 48.416573 / -122.651435

SHEET: 4 OF 8 DATE: JUNE 30, 2025

PROPOSED PROJECT: PIER REMOVAL

IN: BOWMAN BAY
NEAR/AT: ANACORTES, WA
COUNTY: SKAGIT STATE: WA
SEC: 23 T: 34 N R: 1 E
DATUM: BOWMAN BAY NAVD88 = 0.0'

File: Q:\SEA\232222\20 CADD\Active\JARPA\232222_JARPA_FIG-05

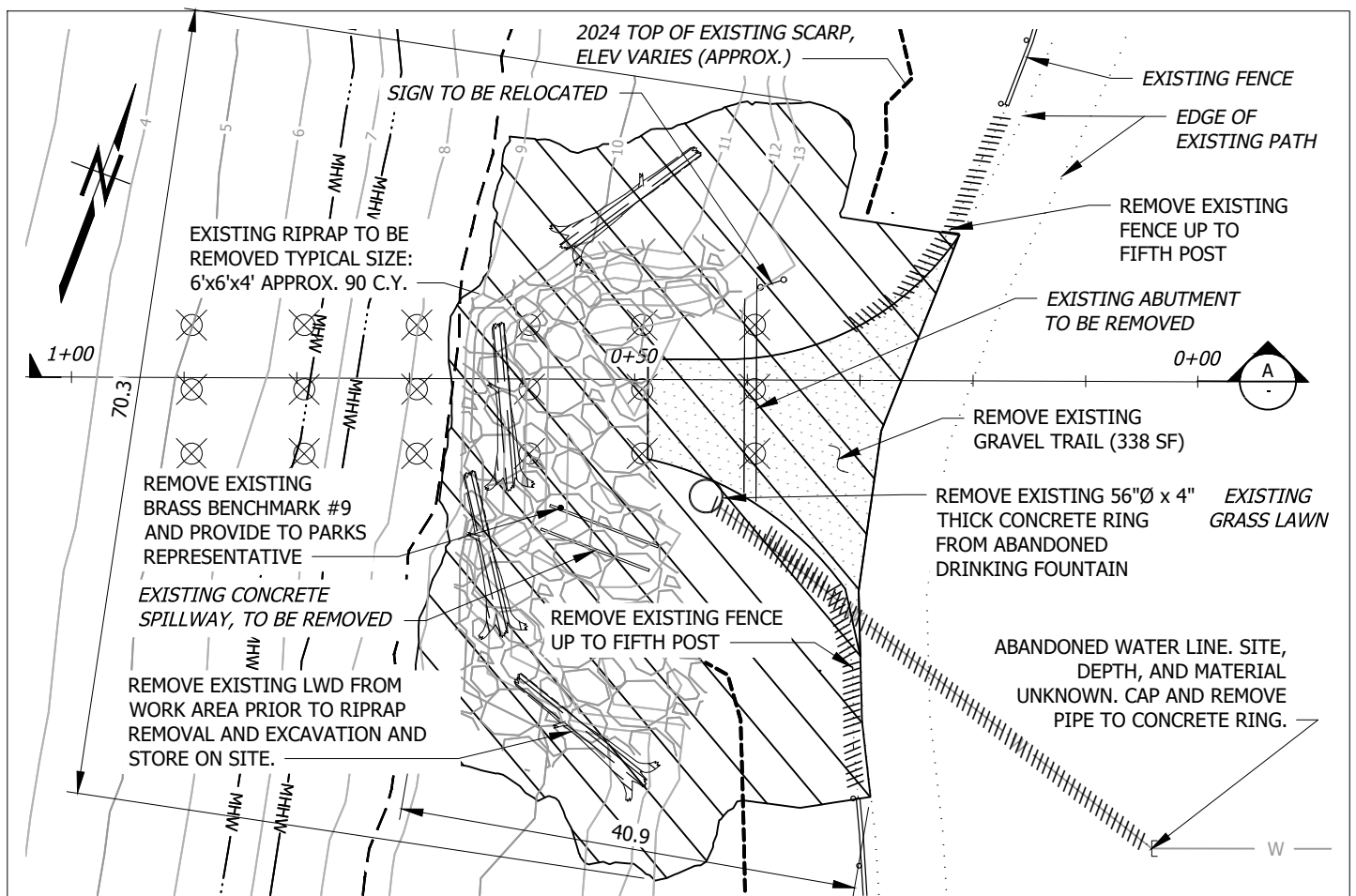

LEGEND:

- DEMOLITION
- EXISTING ELEVATION CONTOUR
- OHWM/HTL, 8.61 FT NAVD88
- MHHW, 7.25 FT NAVD88
- EXISTING LARGE WOODY DEBRIS
- MHW, 6.60 FT NAVD88
- EXISTING WATER LINE
- PILE REMOVAL
- 2024 TOP OF SCARP (APPROX.)

- EXISTING GRAVEL TRAIL REMOVAL
- CUT
- EXISTING RIPRAP REMOVAL

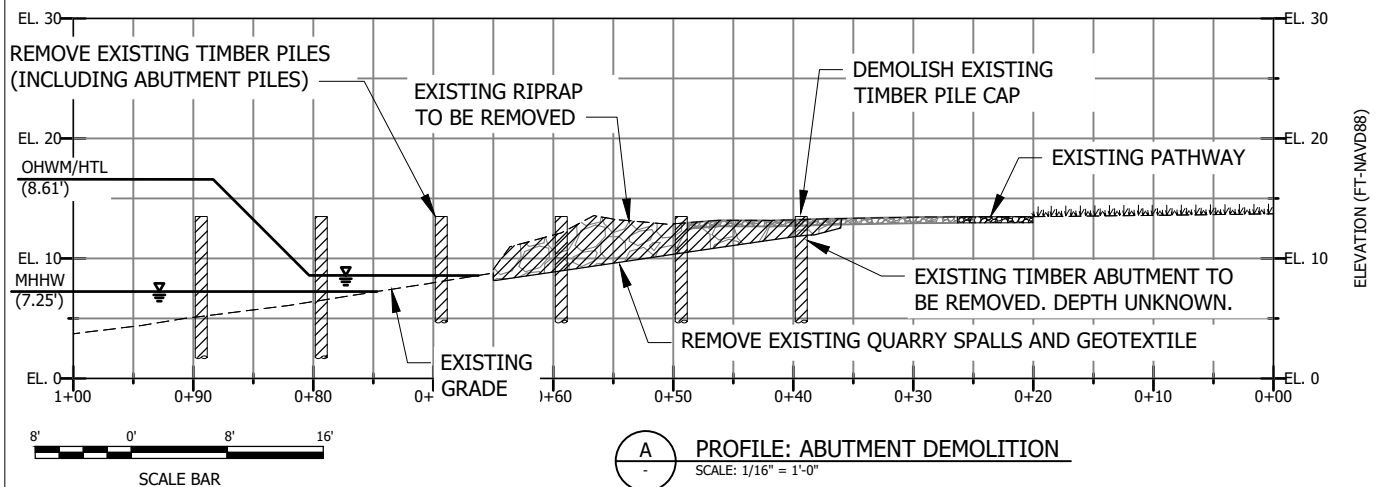

USACE REFERENCE: TBD

APPLICANT: WASHINGTON STATE PARKS

ADJACENT PROPERTY OWNERS:

1) STATE OF WASHINGTON

LOCATION: BOWMAN BAY
DECEPTION PASS STATE PARK
4399 BOWMAN BAY RD
ANACORTES, WA 98221

LAT/LONG: 48.416573 / -122.651435

SHEET: 5 OF 8 DATE: JUNE 30, 2025

PROPOSED PROJECT: PIER REMOVAL

IN: BOWMAN BAY
NEAR/AT: ANACORTES, WA
COUNTY: SKAGIT STATE: WA
SEC: 23 T: 34 N R: 1 E
DATUM: BOWMAN BAY NAVD88 = 0.0'

File: Q:\SEA\232222\20 CADD\Active\JARPA\232222_JARPA_FIG-06

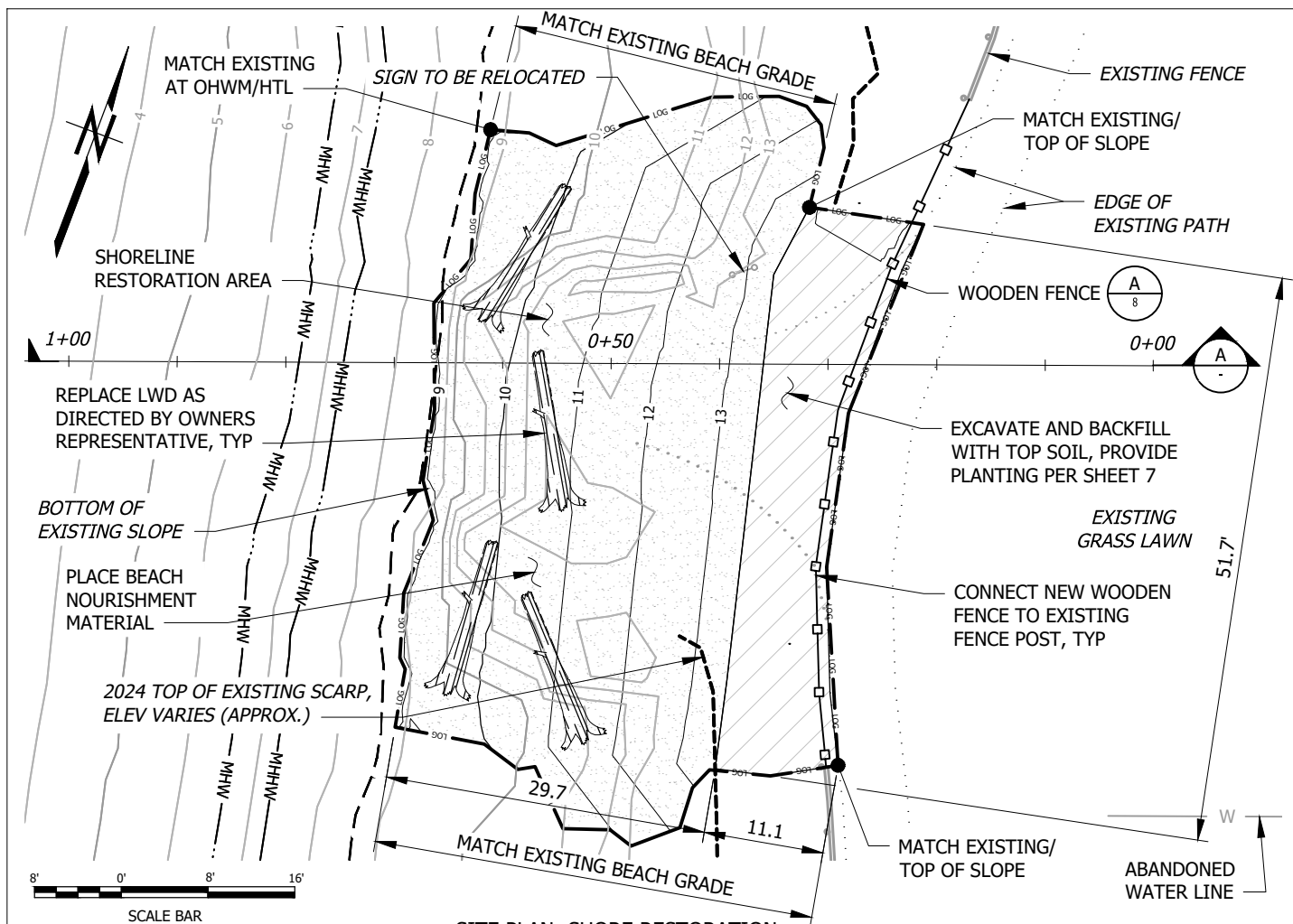

SITE PLAN: SHORE RESTORATION

SCALE: 1/16" = 1'-0"

LEGEND:

— X —	PROPOSED ELEVATION CONTOUR	— MHW —	MHW, 6.60 FT NAVD88		PLANTING AREA, SEE PLANTING SCHEDULE ON SHEET 7
— X —	EXISTING ELEVATION CONTOUR	— W —	WATER LINE		BEACH NOURISHMENT FILL, SEE SHEET 7 FOR GRADATION
— — —	OHWL/HTL, 8.61 FT NAVD88	— □ —	WOODEN FENCE	— LOG — LOG —	LIMITS OF GRADING
— MHHW —	MHHW, 7.25 FT NAVD88	— — —	2024 TOP OF SCARP (APPROX.)		
	REPLACED LARGE WOODY DEBRIS				

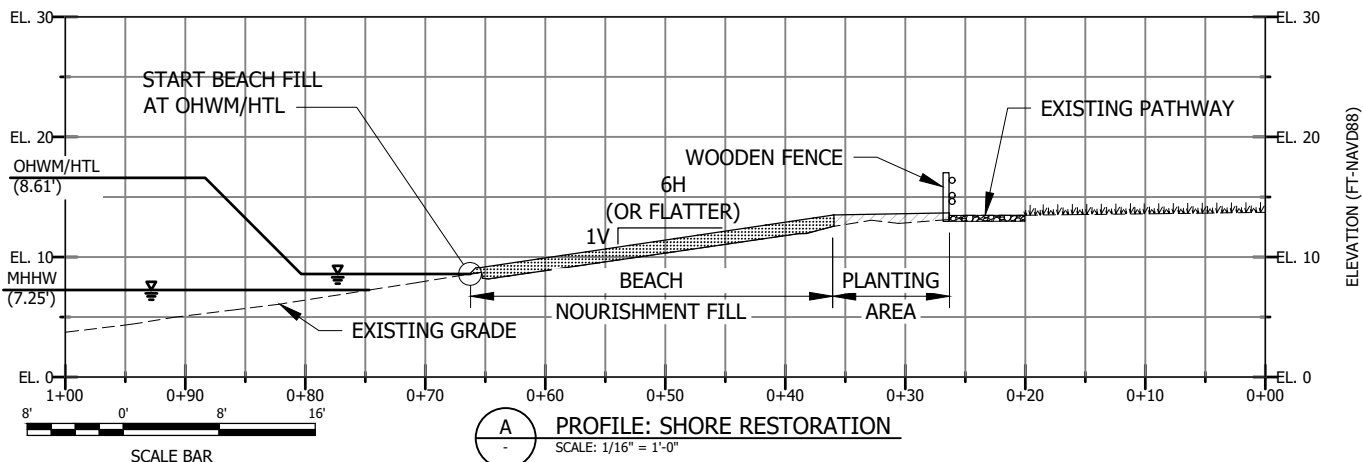

PROFILE: SHORE RESTORATION

SCALE: 1/16" = 1'-0"

USACE REFERENCE: TBD

APPLICANT: WASHINGTON STATE PARKS

ADJACENT PROPERTY OWNERS:

1) STATE OF WASHINGTON

LOCATION: BOWMAN BAY
DECEPTION PASS STATE PARK
4399 BOWMAN BAY RD
ANACORTES, WA 98221

LAT/LONG: 48.416573 / -122.651435

SHEET: 6 OF 8 DATE: JUNE 30, 2025

PROPOSED PROJECT: PIER REMOVAL

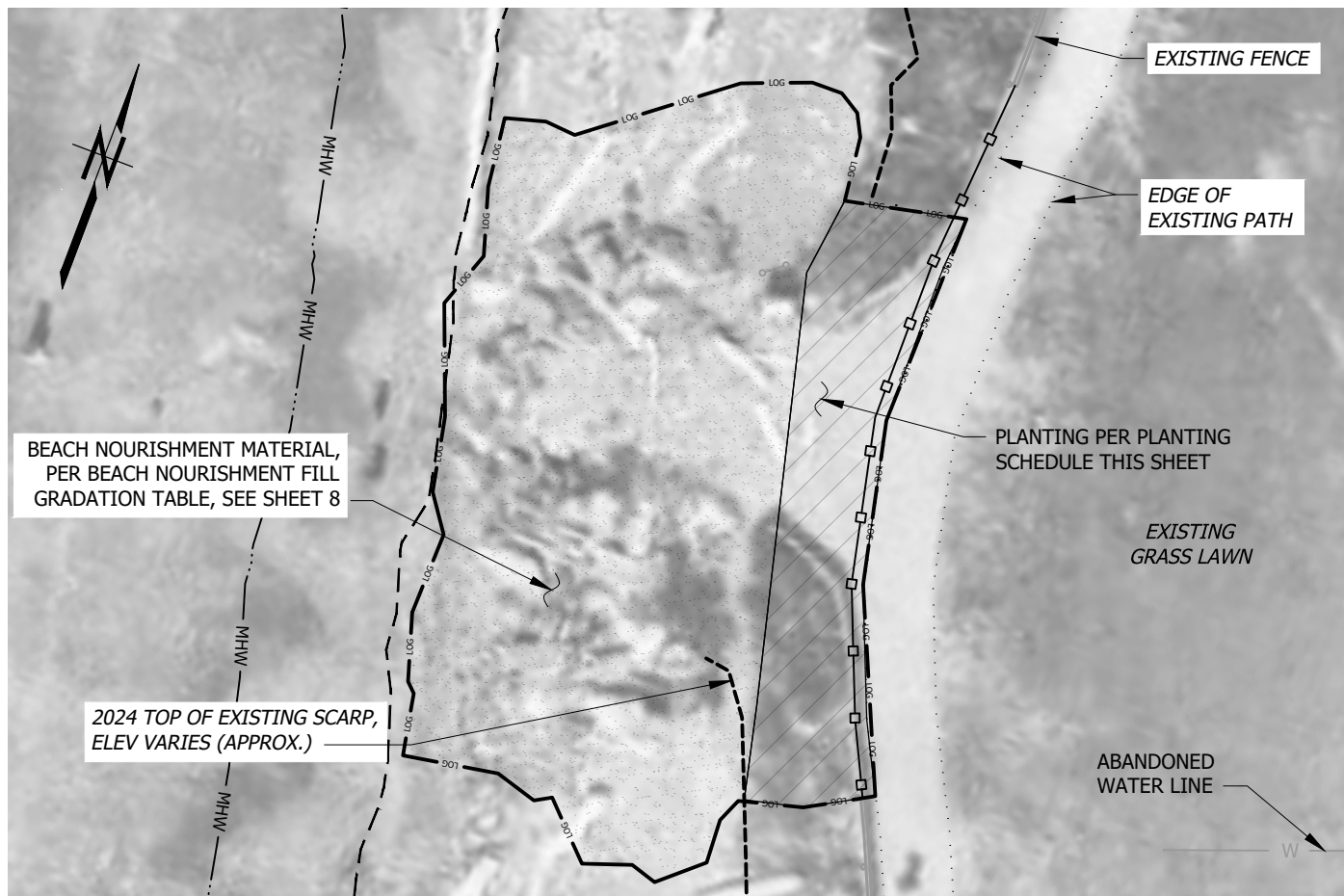

IN: BOWMAN BAY
NEAR/AT: ANACORTES, WA
COUNTY: SKAGIT STATE: WA
SEC: 23 T: 34 N R: 1 E
DATUM: BOWMAN BAY NAVD88 = 0.0'



SITE PLAN: BEACH FILL AND PLANTING

SCALE: 1/16" = 1'-0"

LEGEND:

— — — — — OHWM/HTL, 8.61 FT NAVD88	W — — — — — WATER LINE	 PLANTING AREA, SEE PLANTING SCHEDULE
- · · · — — MHHW — MHHW, 7.25 FT NAVD88	— □ — □ — WOODEN FENCE	 BEACH NOURISHMENT FILL, SEE SHEET 6 & 8
— · · · — — MHW — MHW, 6.60 FT NAVD88	— — — — — 2024 TOP OF SCARP (APPROX.)	— LOG — LOG — LIMITS OF GRADING

PLANTING SCHEDULE

COMMON NAME	SCIENTIFIC NAME	SPACING	QUANTITY	PLANTING NOTES
COASTAL STRAWBERRY	FRAGARIA CHILOENSIS	DETERMINED ONSITE AT TIME OF PLANTING	TO BE DETERMINED	SOILS MAY BE AMENDED WITH TOPSOIL, TOPPED WITH MULCH. PLANTS WILL BE TRANSPLANTED FROM POTS. SIZE WILL BE DEPENDENT UPON AVAILABILITY. PLANTING WILL BE IN SPRING AS PLANTS EMERGE FROM DORMANCY. USE LIVE STAKES FOR SCOULER'S WILLOW PLANTINGS.
BEACH PEA	LATHERYUS MARITIMUS			
SEA PLANTAIN	PLANTAGO MARITIMA			
NOOTKA ROSE	ROSA NUTKANA	3' TO 4' OC	72	
OCEANSPRAY	HOLODISCUS BICOLOR			
TALL OREGON GRAPE	MAHONIA AQUIFOLIUM			
SCOULER'S WILLOW	SALIX SCOULERIANA	6' OC	18	

USACE REFERENCE: TBD

APPLICANT: WASHINGTON STATE PARKS

ADJACENT PROPERTY OWNERS:

1) STATE OF WASHINGTON

LOCATION: BOWMAN BAY
DECEPTION PASS STATE PARK
4399 BOWMAN BAY RD
ANACORTES, WA 98221

LAT/LONG: 48.416573 / -122.651435

SHEET: 7 OF 8 DATE: JUNE 30, 2025

PROPOSED PROJECT: PIER REMOVAL

IN: BOWMAN BAY
NEAR/AT: ANACORTES, WA
COUNTY: SKAGIT STATE: WA
SEC: 23 T: 34 N R: 1 E
DATUM: BOWMAN BAY NAVD88 = 0.0'

File: Q:\SEA\232222\20 CADD\Active\JARPA\232222_JARPA_FIG-07

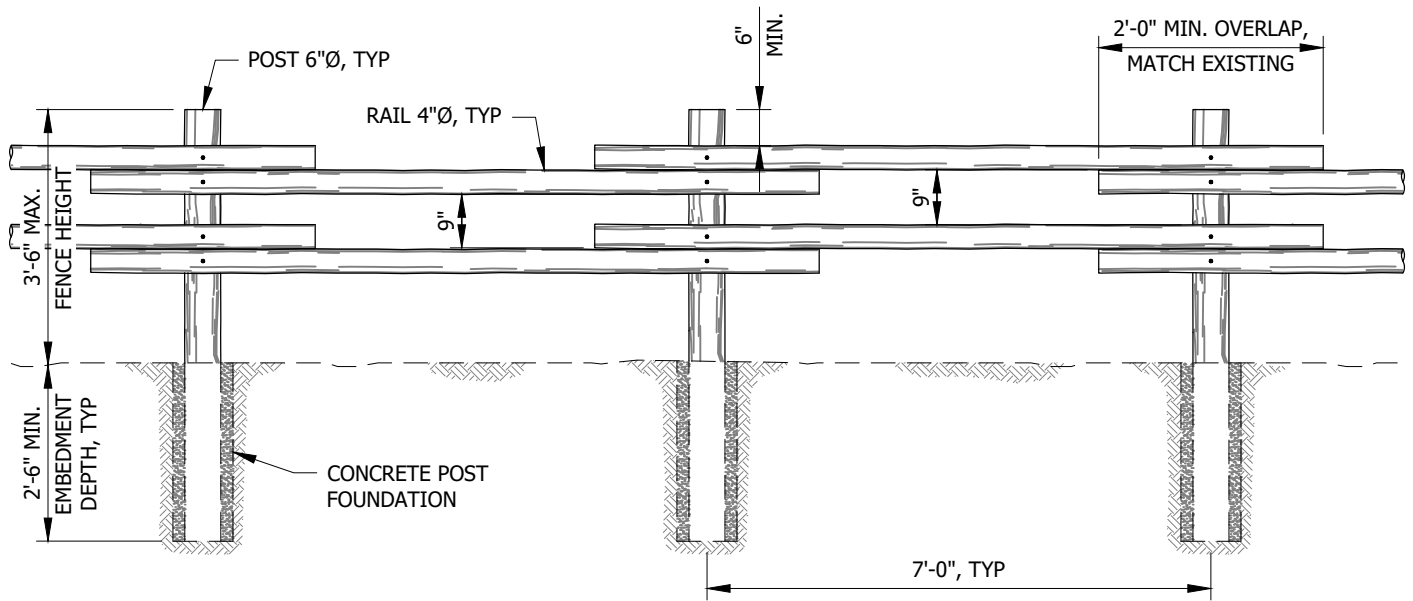

PROPOSED WOODEN FENCE - ELEVATION

SCALE: 3/8" = 1'-0"

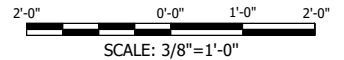

BEACH NOURISHMENT FILL GRADATION	
SIEVE SIZE	PERCENT PASSING
6 IN	100
2 IN	90-100
1 IN	80
0.38 IN	35-60
#10	0-10
#100	0-5

NOTE: BEACH NOURISHMENT FILL PLACEMENT IS DETAILED ON SHEETS 6 & 7.

USACE REFERENCE: TBD

APPLICANT: WASHINGTON STATE PARKS

ADJACENT PROPERTY OWNERS:

1) STATE OF WASHINGTON

LOCATION: BOWMAN BAY
DECEPTION PASS STATE PARK
4399 BOWMAN BAY RD
ANACORTES, WA 98221

LAT/LONG: 48.416573 / -122.651435

SHEET: 8 OF 8 DATE: JUNE 30, 2025

PROPOSED PROJECT: PIER REMOVAL

IN: BOWMAN BAY
NEAR/AT: ANACORTES, WA
COUNTY: SKAGIT STATE: WA
SEC: 23 T: 34 N R: 1 E
DATUM: BOWMAN BAY NAVD88 = 0.0'