



ADDENDUM NO. 2

WASHINGTON STATE PARKS AND RECREATION COMMISSION
WILLAPA HILLS STATE PARK TRAIL
MENLO TRAILHEAD
NW-C1219

DATE: June 04, 2025

ATTENTION TO PLANHOLDERS OF RECORD. The following revisions are hereby made a part of the Contract Documents. Please be sure to acknowledge all Addenda on the Bid Form.

PROJECT MANUAL

I. CHANGES TO THE SPECIFICATIONS

The bid due date has been changed to 1:00PM, Thursday, June 12, 2025. This was to allow time for the engineer to process and craft Addendum #2.

DRAWINGS

The Following plan and specification changes shall be incorporated into the bid proposal and subsequent construction:

Sheet 7 Revise: RETAINING WALL NOTES:

Line 5: Remove the word "NO" and add: SEE SPECIFICATIONS

Line 6: Remove the word "NO" and add: SEE SPECIFICATIONS

Attachments:

— NW-C1219 WHT-Menlo Trailhead-Drawing Sheet 7 of 15

Brett Taylor

Brett Taylor, Procurement Coordinator
Contracts and Grants Program

06/04/25

Date

END OF ADDENDUM NO. 2

- NOTE:
- ALL PAVEMENT MARKINGS DIMENSION SHALL COMPLY WITH U.S. DOT MANUAL ON UNIFORM TRAFFIC CONTROL DEVICES AND ASSHTO GUIDE FOR THE PLANNING, DESIGN DESIGN, AND OPERATION OF PEDESTRIAN FACILITIES.
 - ALL PAVEMENT MARKINGS SHALL BE THERMOPLASTIC.

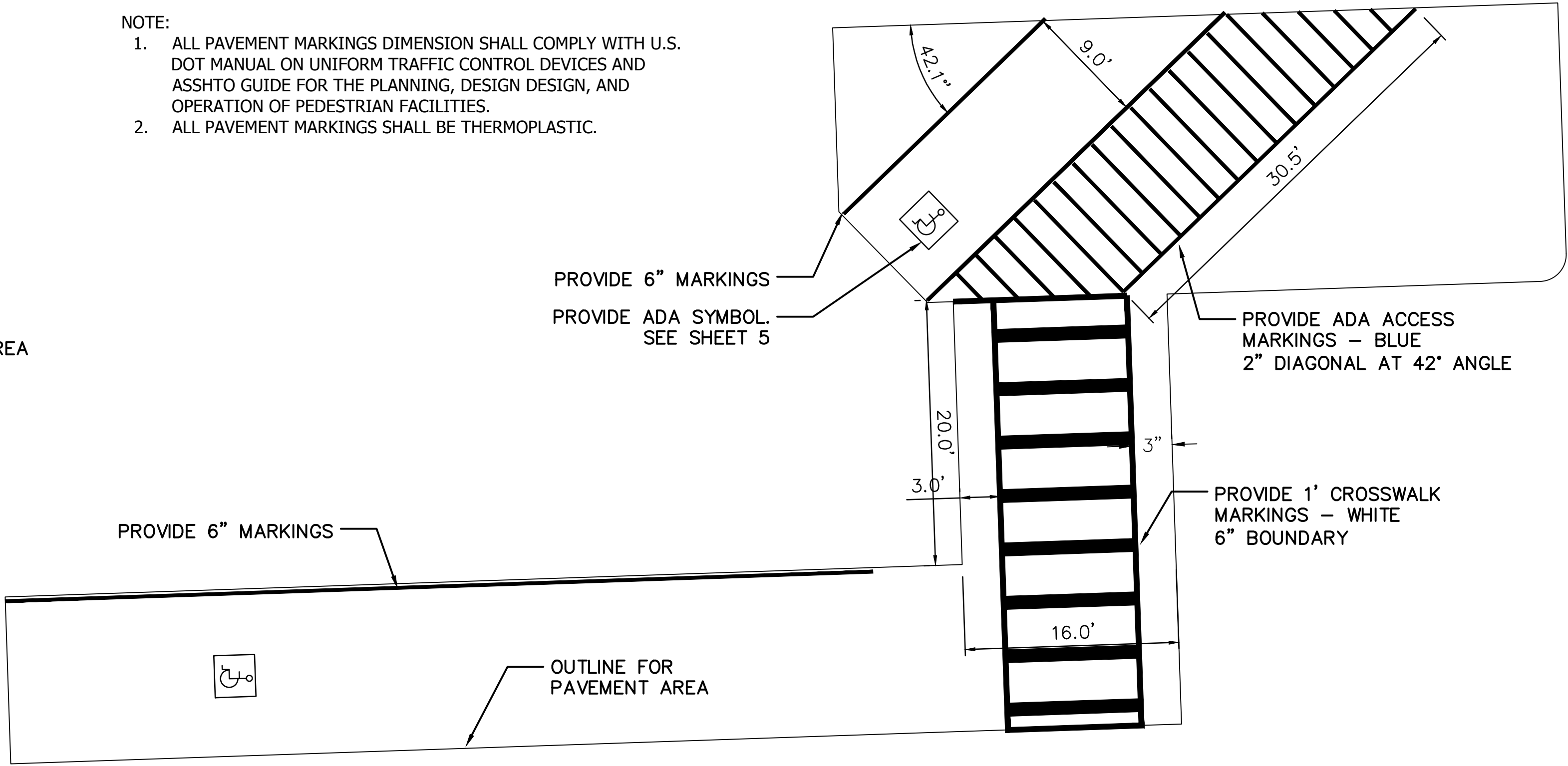
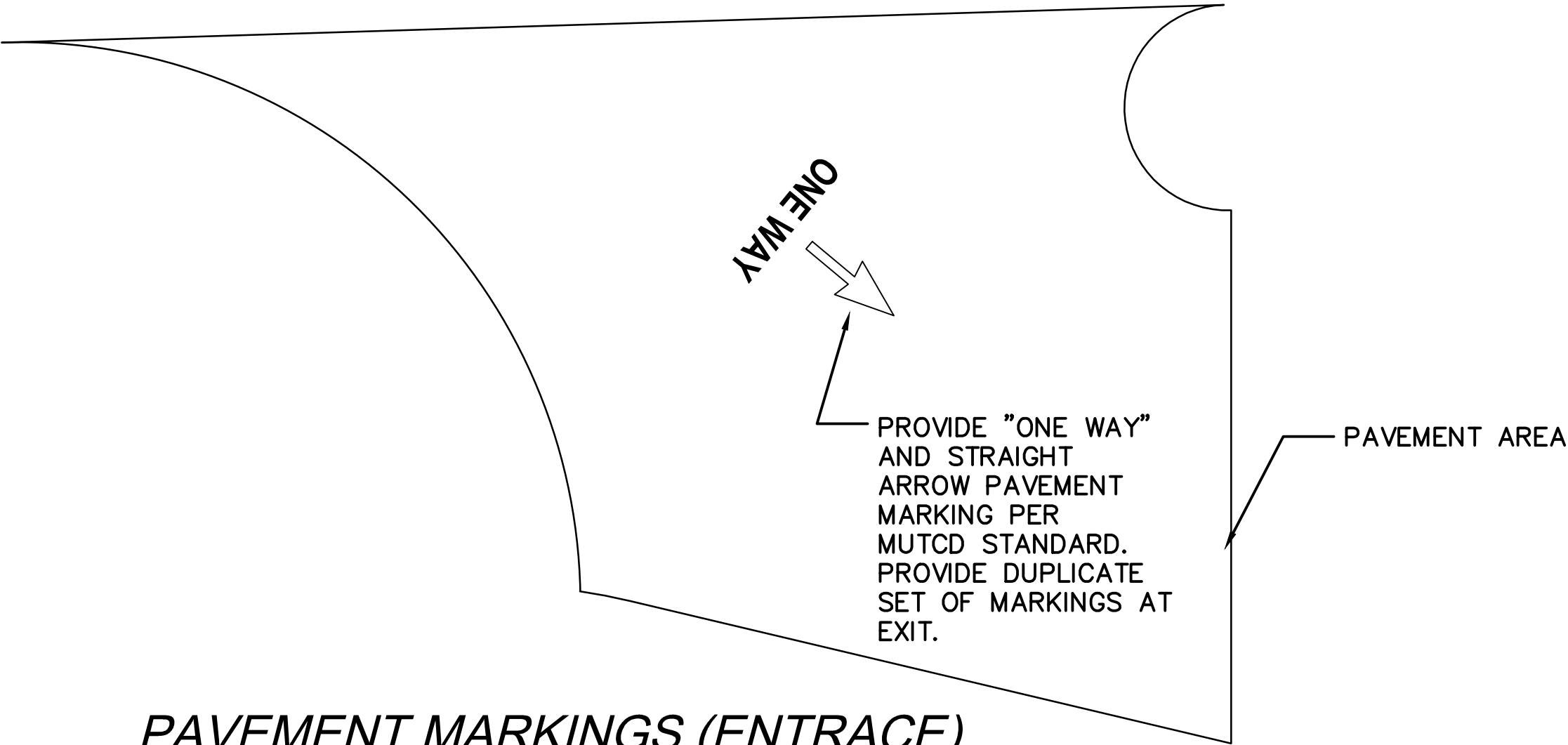

PAVEMENT MARKINGS (ADA CROSSING)

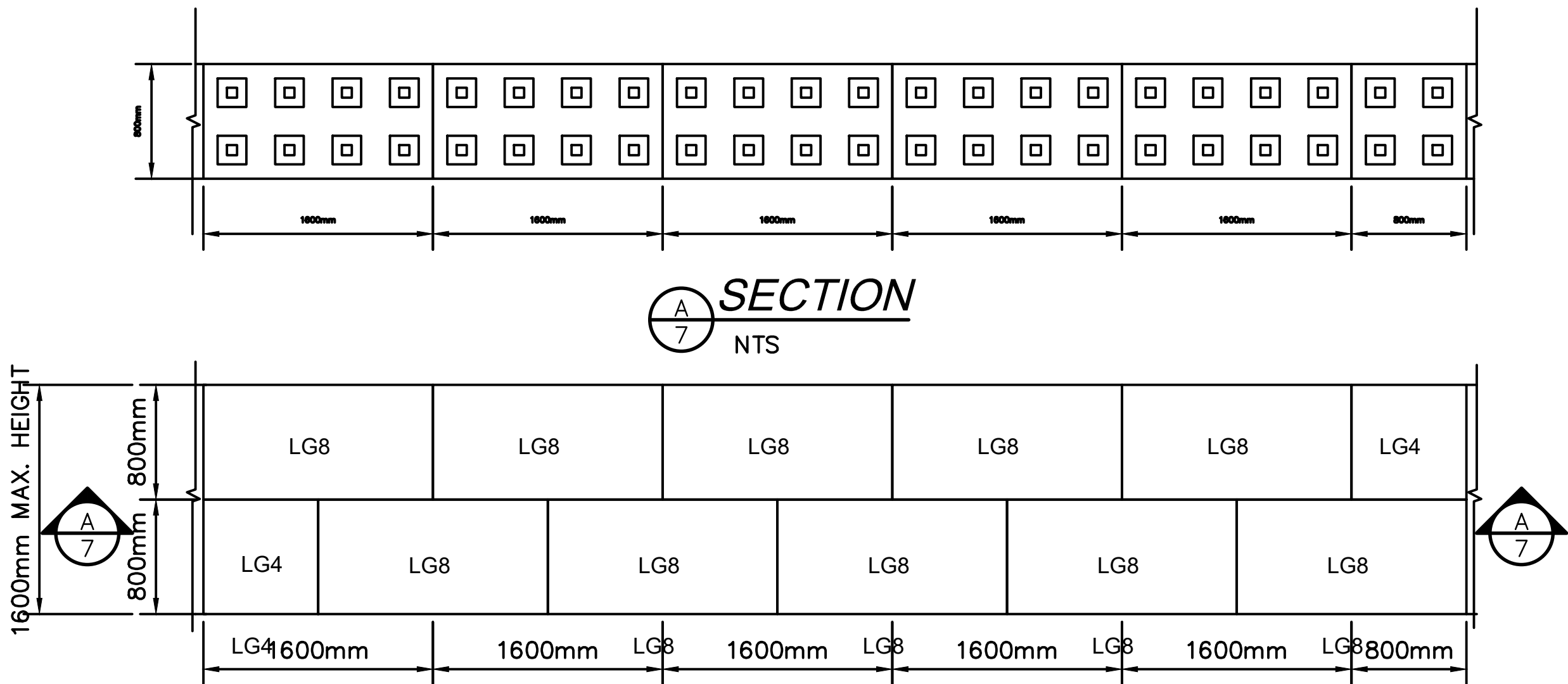

FRONT VIEW - RETAINING WALL TYPICAL ARRANGEMENT

LEGATO BLOCK PROJECT TOTAL

LEGATO BLOCK SCHEDULE - GRAND TOTAL		
CODE	DIMENSIONS	COUNT
LG8	1600x800x800x2.4t	206
LG4	800x800x800x2.4t	10

* 1600mm equals 5.25 feet approximately

RETAINING WALL NOTES:

- RETAINING WALLS MUST BE INSTALLED AND CONSTRUCTED ACCORDING TO THE CONTRACT DRAWINGS.
- CONTRACTOR SHALL VERIFY THE ACTUAL LENGTH OF RETAINING WALL ONSITE.
- RETAINING WALL UNITS AND INSTALLATION SHALL CONFORM TO THE ELITE KELLEY BLOCK (LEGATO BLOCK) RETAINING WALL SYSTEMS SPECIFICATIONS GUIDELINES. OR APPROVED EQUAL.
- BACKFILL NATIVE SOIL BEHIND THE RETAINING WALL
- ~~NO~~ GEOGRID IS REQUIRED SEE SPECIFICATIONS
- ~~NO~~ DRAIN PIPE IS REQUIRED BEHIND THE WALL SEE SPECIFICATIONS

NOTE:
CENTER WHEELSTOP IN PARKING SPACE.

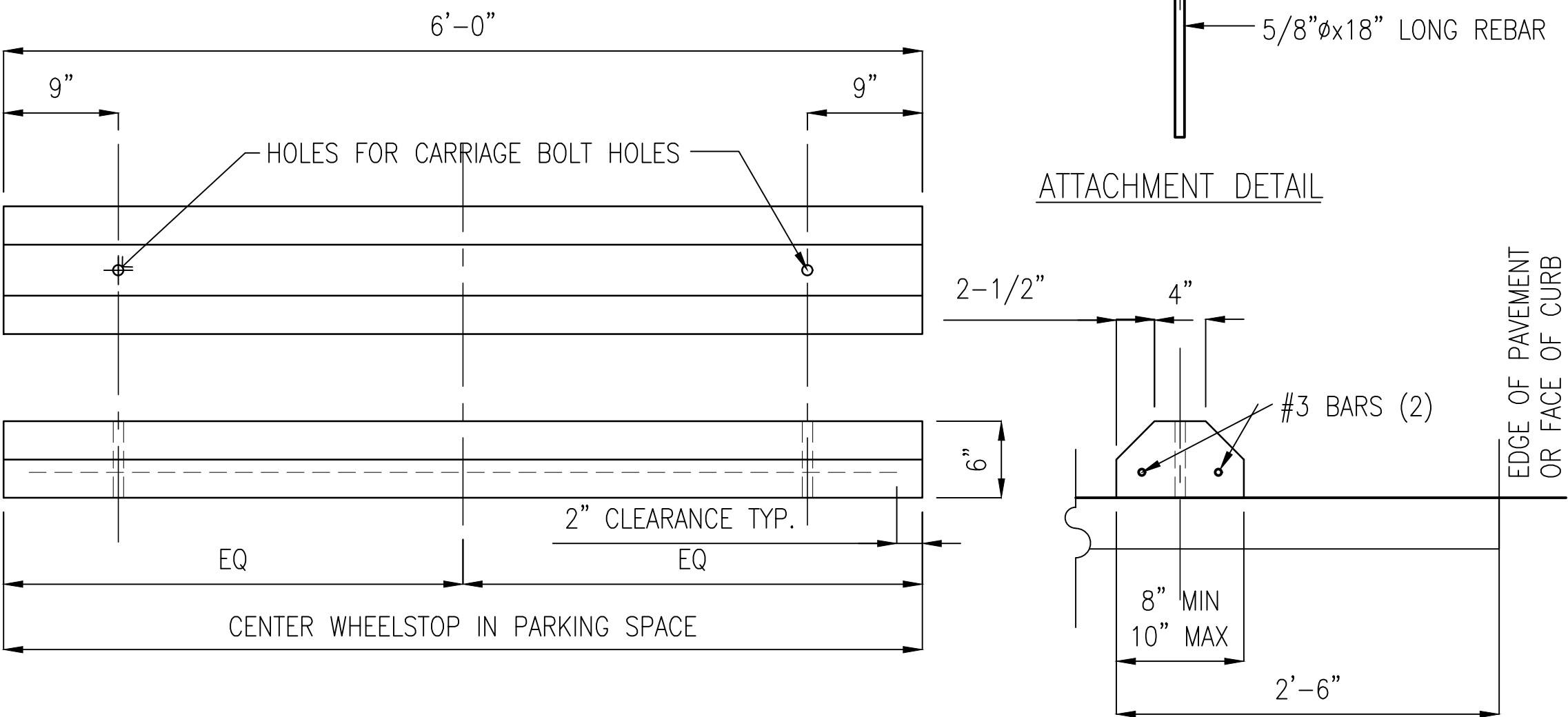

CAD NO.W500-SW10-2023-MASTER

ACTION	BY	DATE
DESIGNED	HL	02/08/2023
DRAWN	XXX	XX/XX/XX
CHECKED (FIELD)	XXX	XX/XX/XX
CHECKED (HDQTS.)	XXX	XX/XX/XX

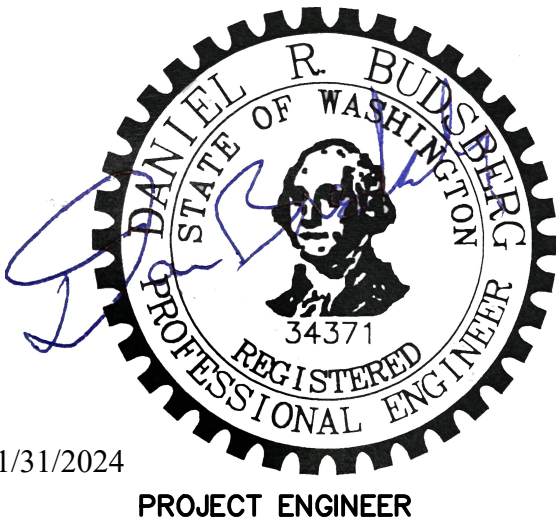

WASHINGTON
STATE
PARKS
AND
RECREATION
COMMISSION

WILLAPA HILLS
STATE PARK
TRAIL

MENLO
TRAILHEAD

PAVEMENT
MARKING AND
MISC. DETAILS

SCALE

AS SHOWN

PARKS FILE#